

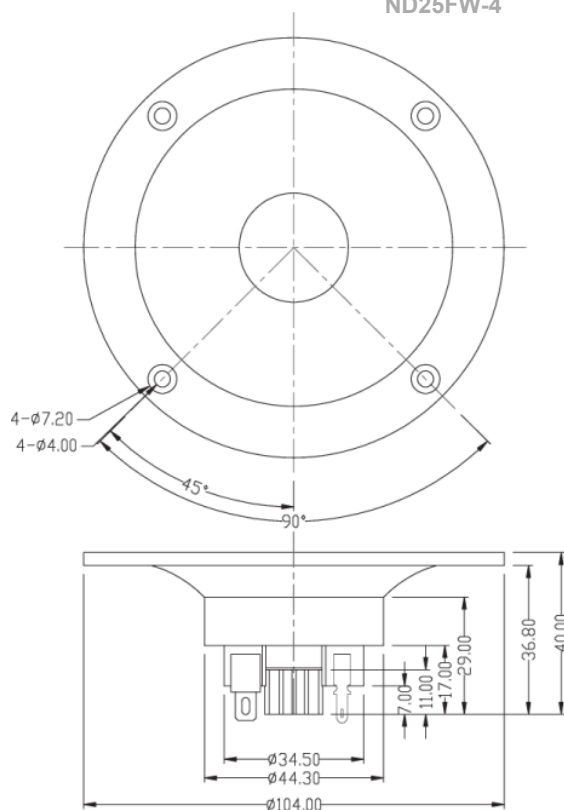

ND25FW-4 1" Soft Dome Neodymium Tweeter with Waveguide 4 Ohm

ND25FW-4



FEATURES

- Waveguide-loaded 1" treated silk dome
- Waveguide provides controlled directivity and higher efficiency
- High-strength neodymium motor with heatsink and ferrofluid cooling
- Low Fs of 1,350 Hz can accommodate crossover points as low as 2,500 Hz
- Standard 104 mm tweeter cutout for easy integration into many existing systems

PARAMETERS

| | |
|-----------------------------|-------------------|
| Impedance | 4 ohms |
| Re | 3.2 ohms |
| Le | 0.04 mH |
| Fs | 1,350 Hz |
| Qms | N/A |
| Qes | N/A |
| Qts | N/A |
| Mms | N/A |
| Cms | N/A |
| Sd | N/A |
| Vd | N/A |
| BL | N/A |
| Vas | N/A |
| Xmax | N/A |
| VC Diameter | 1" |
| SPL | 91 dB @ 1W/1m |
| RMS Power Handling | 20 watts |
| Usable Frequency Range (Hz) | 2,500 - 20,000 Hz |

IMPEDANCE/PHASE

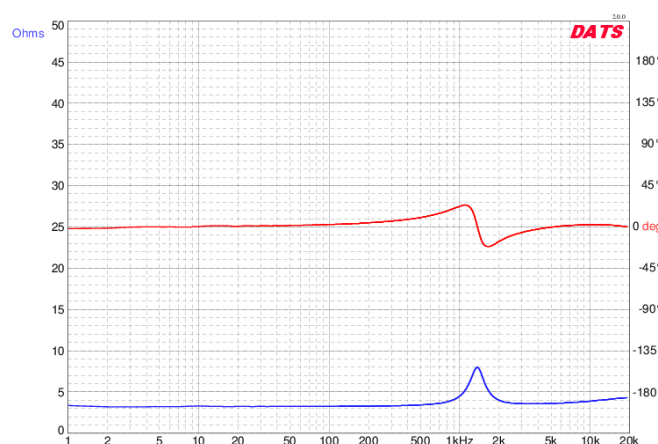

FREQUENCY RESPONSE

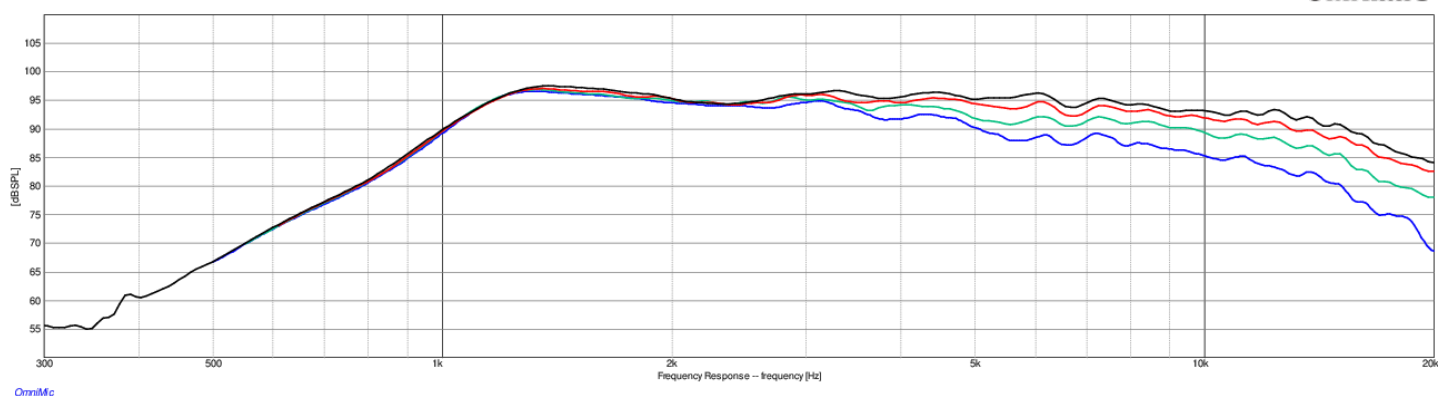

Note: 1/24th octave smoothing - nearfield response included in graph below 450 Hz.

Black = 0°
Red = 15°
Green = 30°
Blue = 45°