



# ET 338-104

Elite Tweeter,  
Ø 104mm, 8Ω



### Features:

- \* 104mm IDR™ Improved Dispersion Recess design aluminum face plate
- \* Large Hexatech™ aluminum voice coil
- \* Replaceable Acuflex™ dome / coil assembly
- \* Triple magnet system
- \* High power handling
- \* Sturdy gold plated input tags

## SPECIFICATIONS

### General Data

|                              |            |                                |
|------------------------------|------------|--------------------------------|
| Overall Dimensions           | <b>DxH</b> | 104mm(4.09")x66mm(2.59")       |
| Nominal Power Handling (DIN) | <b>P</b>   | 200W                           |
| Transient Power 10ms         |            | 1000W                          |
| Sensitivity 1W/1M            |            | 92.5dB SPL                     |
| Frequency Response           |            | 1,800-20,000 Hz                |
| Cone/Dome Material           |            | Acuflex™ hand coated soft dome |
| Net Weight                   | <b>Kg</b>  | 1.08                           |

### Electrical Data

|                              |            |        |
|------------------------------|------------|--------|
| Nominal Impedance            | <b>Z</b>   | 8Ω     |
| DC Resistance                | <b>Re</b>  | 5.2Ω   |
| Voice Coil Inductance @ 1KHz | <b>LBM</b> | 0.09mH |

### Voice Coil and Magnet Parameters

|                        |            |                    |
|------------------------|------------|--------------------|
| Voice Coil Diameter    | <b>DIA</b> | 28mm               |
| Voice Coil Height      |            | 2.7mm              |
| HE Magnetic Gap Height | <b>HE</b>  | 2.5mm              |
| Max. Linear Excursion  | <b>X</b>   |                    |
| Voice Coil Former      |            | Aluminum           |
| Voice Coil Wire        |            | Hexatech™ Aluminum |
| Number Of Layers       |            | 2                  |
| Magnet System Type     |            | Triple Ferrite     |
| B Flux Density         | <b>B</b>   | 1.95 T             |
| BL Product             | <b>BXL</b> | 6.3 N.A            |

### T-S Parameters

|                           |            |                     |
|---------------------------|------------|---------------------|
| Suspension Compliance     | <b>Cms</b> |                     |
| Mechanical Q Factor       | <b>Qms</b> |                     |
| Electrical Q Factor       | <b>Qes</b> |                     |
| Total Q Factor            | <b>Qts</b> |                     |
| Mechanical Resistance     | <b>Rms</b> |                     |
| Moving Mass               | <b>Mms</b> | 0.44 g              |
| Eq. Cas Air Load (liters) | <b>VAS</b> |                     |
| Resonant Frequency        | <b>Fs</b>  | 700 Hz 10%          |
| Effective Piston Area     | <b>SD</b>  | 6.0 cm <sup>2</sup> |

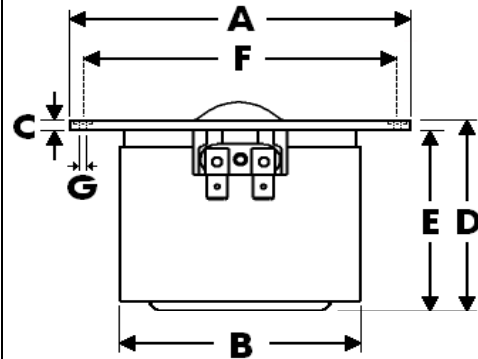
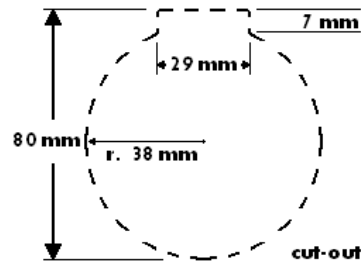

- A - Overall diameter 104mm
- B - Magnet/Chamber diameter 76mm
- C - Flange thickness 3mm
- D - Overall height 66mm
- E - Magnet/Chamber depth 63mm
- F - Mounting holes location diameter 94mm
- G - 6 Mounting holes, at 60° interval, inner hole diameter Ø 3.7mm, pocket h 1mm, Ø 7mm

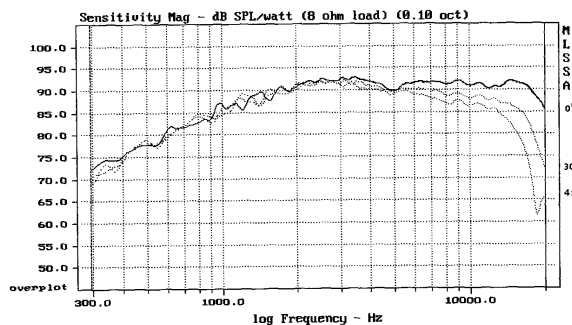
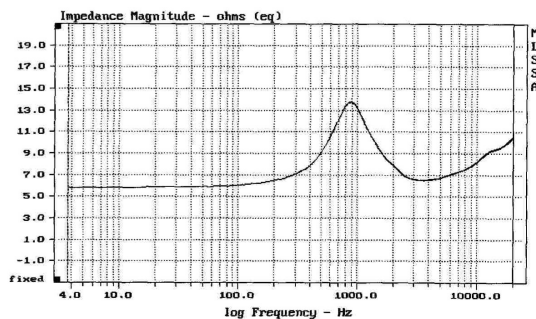

Morel operate policy of continuous product design improvement, consequently specifications are subject to alteration without prior notice.