

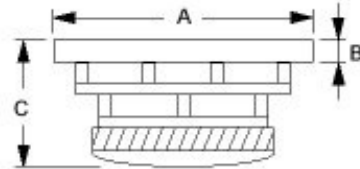

10A772510

Effective Cone Area	326 Cm²
Nominal Impedance	8 Ohms
Resonance Frequency	25 Hz
Equivalent Air Volume	140 Ltrs.
Mecanical Q Factor	2.32
Electrical Q Factor	0.29
Total Q Factor	0.26
Acceleration Factor	259
Nominal Power Handling	200 W
Sensitivity	91 dB
Frequency Response	34-2200 Hz
DC Resistance	5.4 Ohms
Compliance	0.9409 mm/Nm
Mechanical res.	2.916
VC Inductance	0.76 mH
Moving Mass	43.07 g
Force Factor	11.17
Linear Exeursion (X-max)	3.6 mm
Max Exeursion (P-P)	42 mm



A = 275 mm
B = 10 mm
C = 139 mm
Weight = 7.1 kg

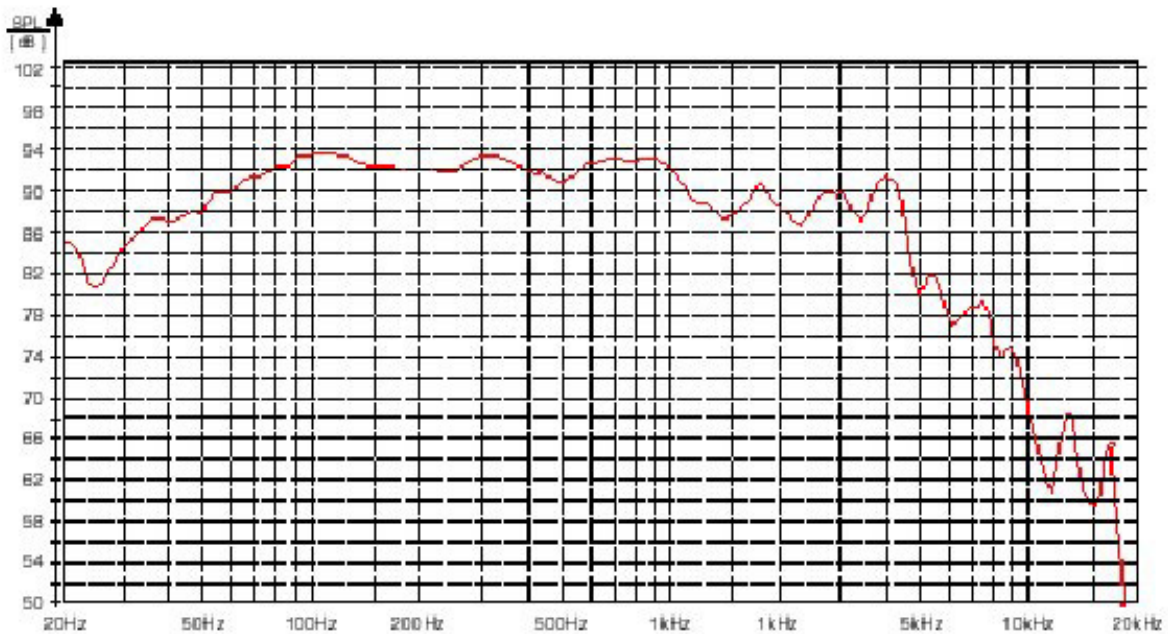

10A772510