

2-Way Crossover Network

LP Type: 3rd-Order Butterworth

LP Desired Corner Frequency: 1500 Hz

HP Type: 3rd-Order Butterworth

HP Desired Corner Frequency: 2500 Hz

C1 = 9.1 μ F, Polypropylene, 0.00535 ohms

C2 = 27 μ F, Polypropylene, 0.00312 ohms

C3 = 51 μ F, Polypropylene, 0.00233 ohms

L1 = 0.22 mH, Air Core (#20), 0.288 ohms

L2 = 0.47 mH, Air Core (#14), 0.134 ohms

L3 = 0.15 mH, Air Core (#14), 0.07 ohms

Tweeter

2.00 dB L-Pad

Rp1 = 1.2 ohms

Rp2 = 24 ohms

Woofer

Impedance EQ

Req = 3.9 ohms

Ce = 20 μ F

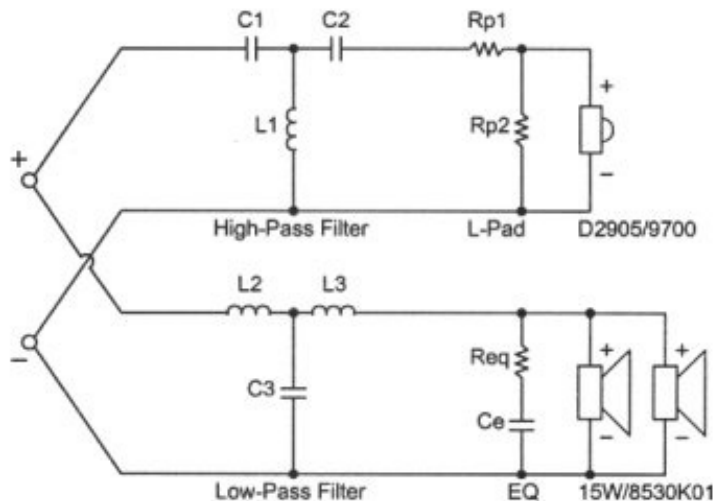

6 3/4"

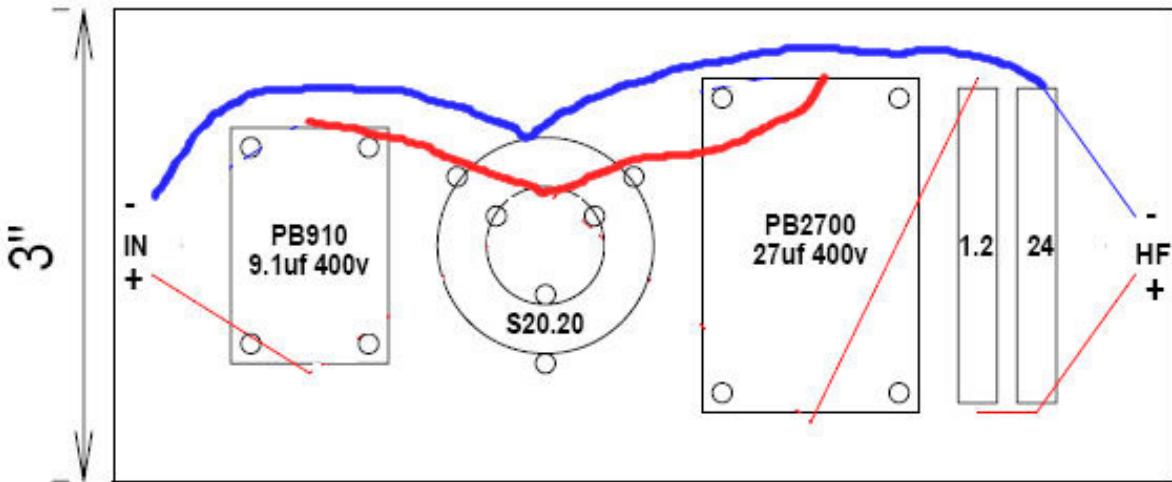

10"

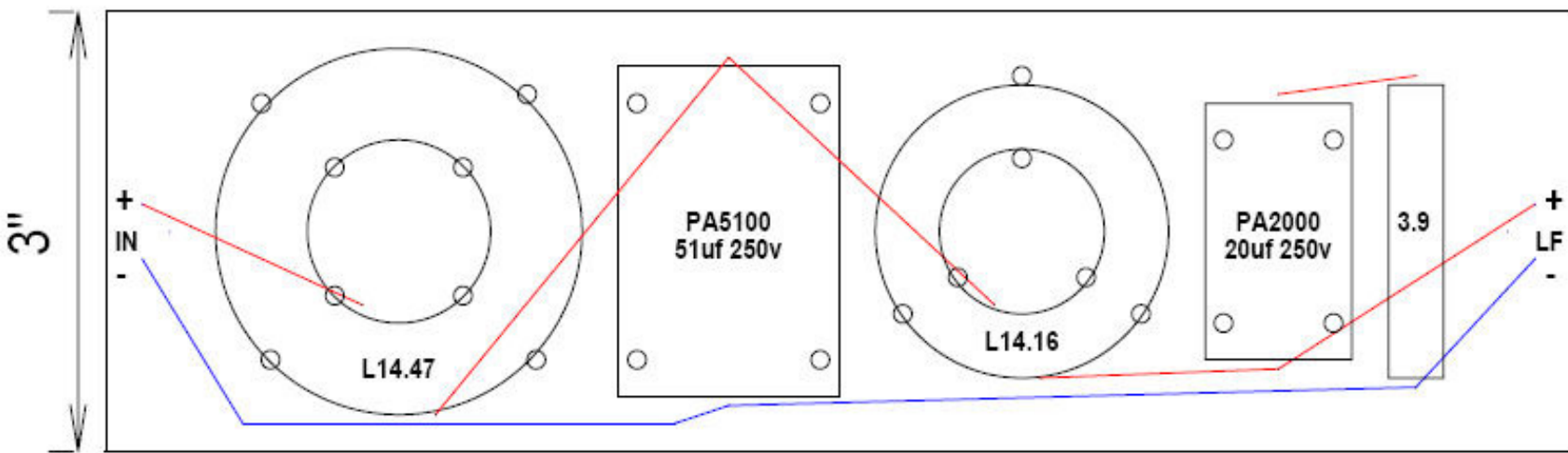

Normalized Amplitude Response (dB-SPL/Hz)

X-over 3 Pro

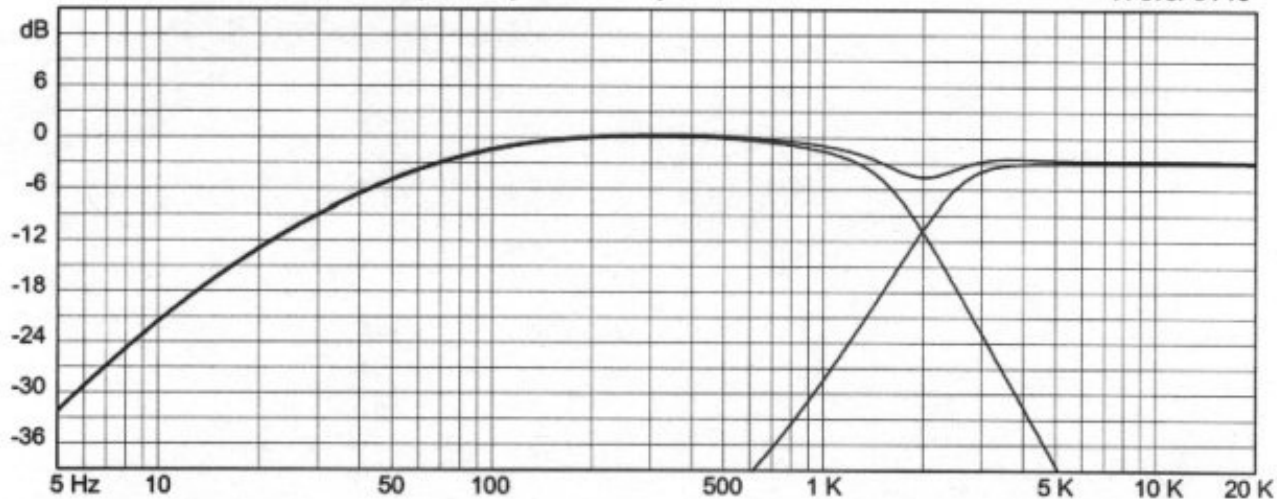

System Impedance (ohms/Hz)

X-over 3 Pro

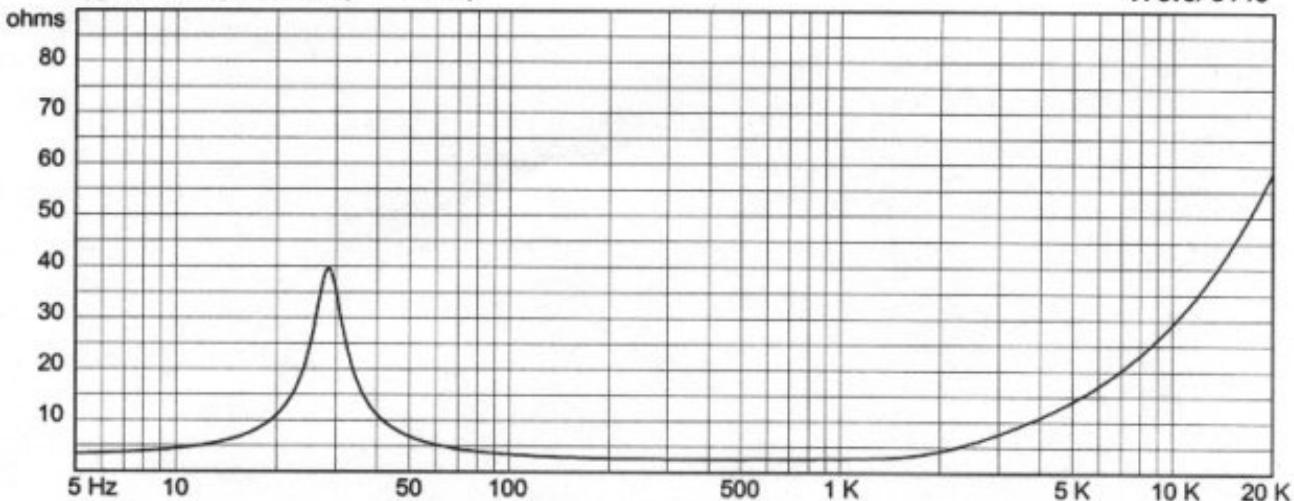

SPEAKER
REAR VIEW

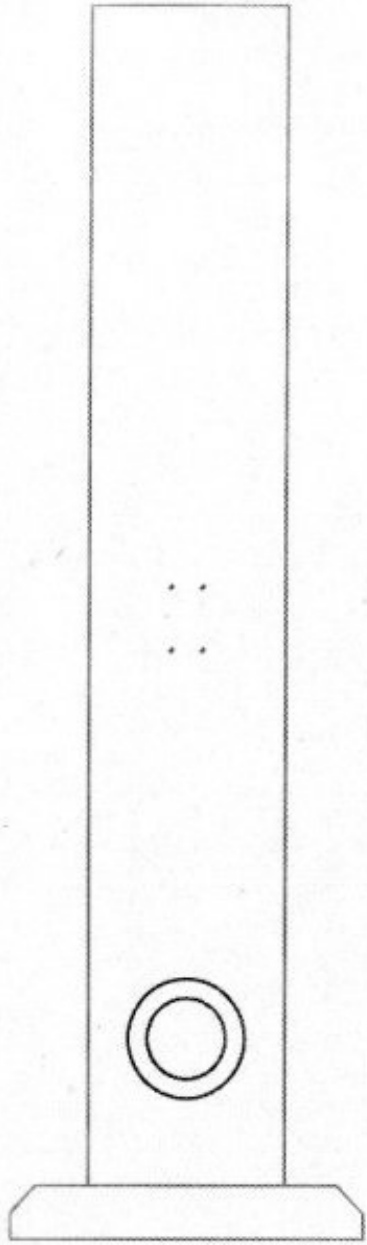

SPEAKER
FRONT VIEW

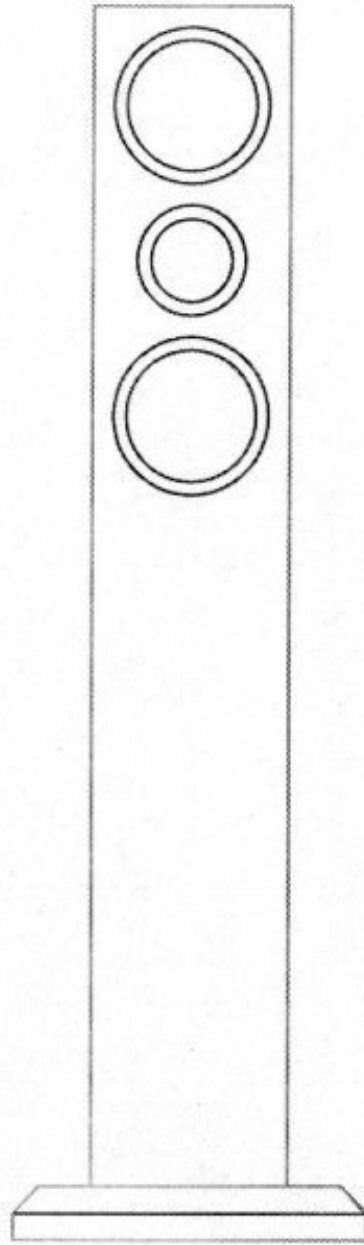

SIDE
SIDE VIEW

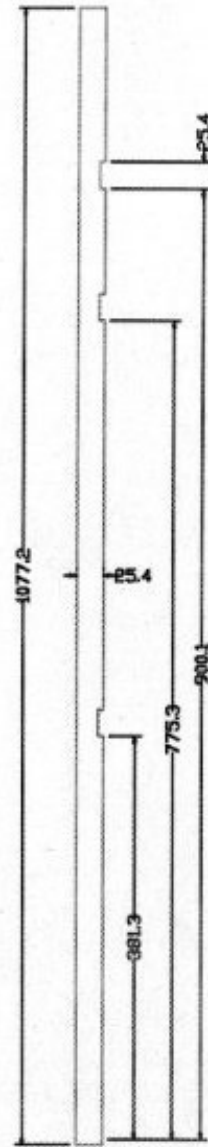

SPEAKER
FRONT VIEW
NO BAFFLE

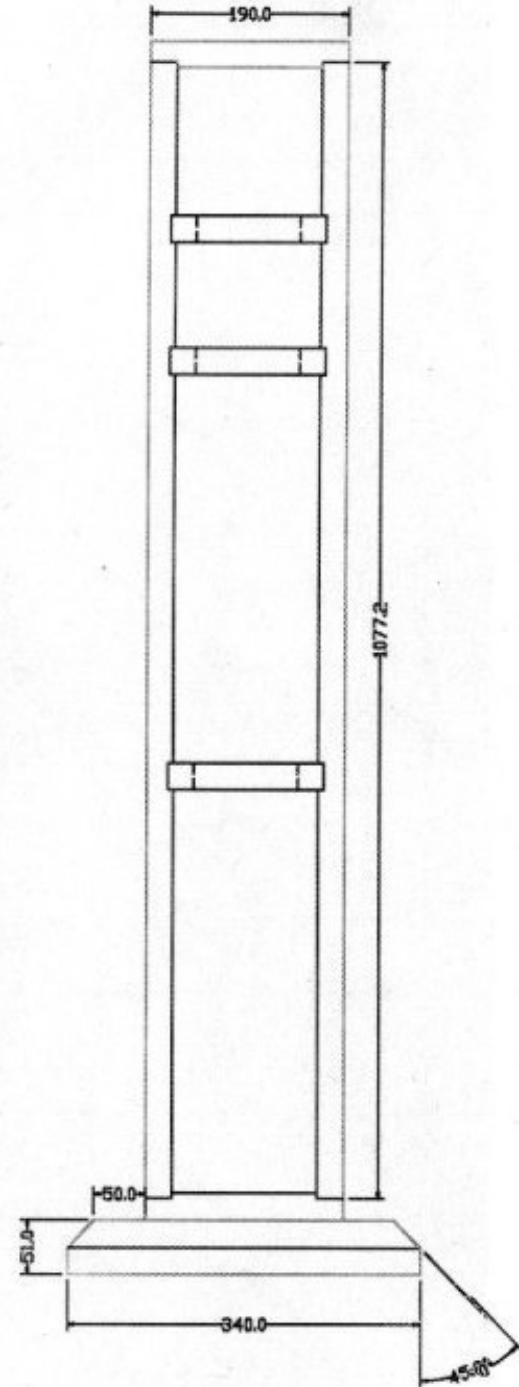

SIDEVIEW
NO SIDE

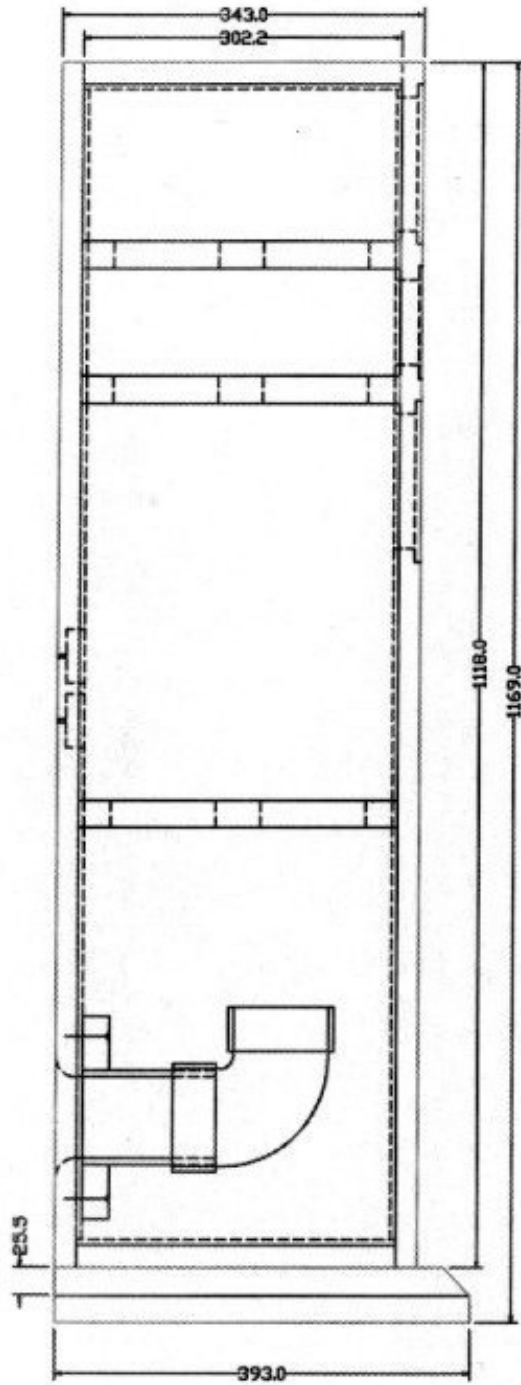

BACK
FRONT VIEW

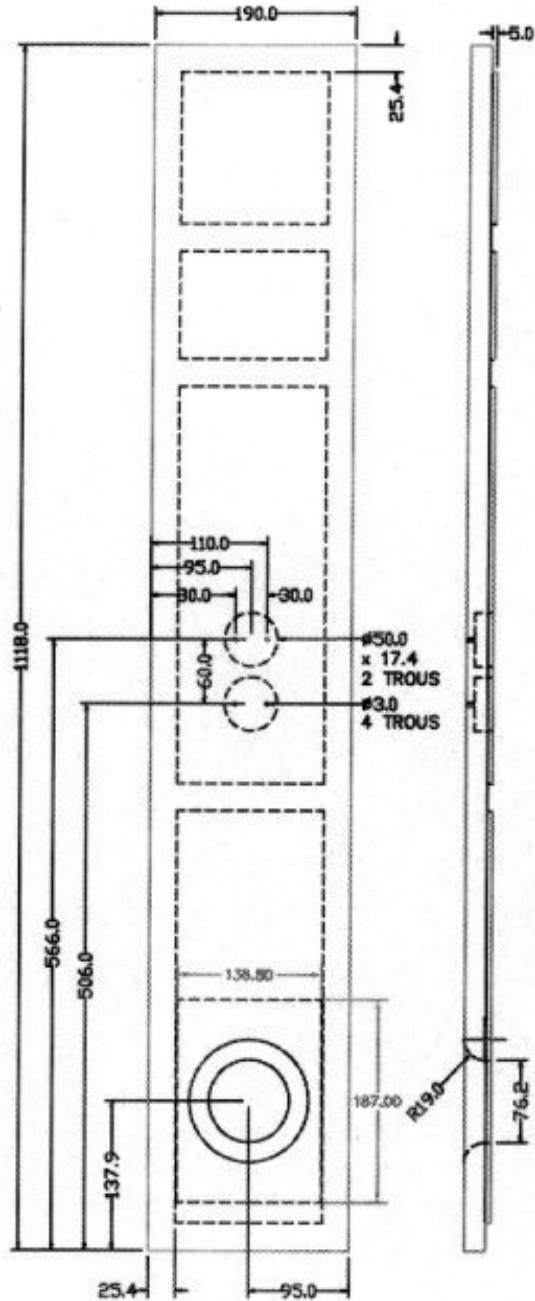

BACK
SIDE VIEW

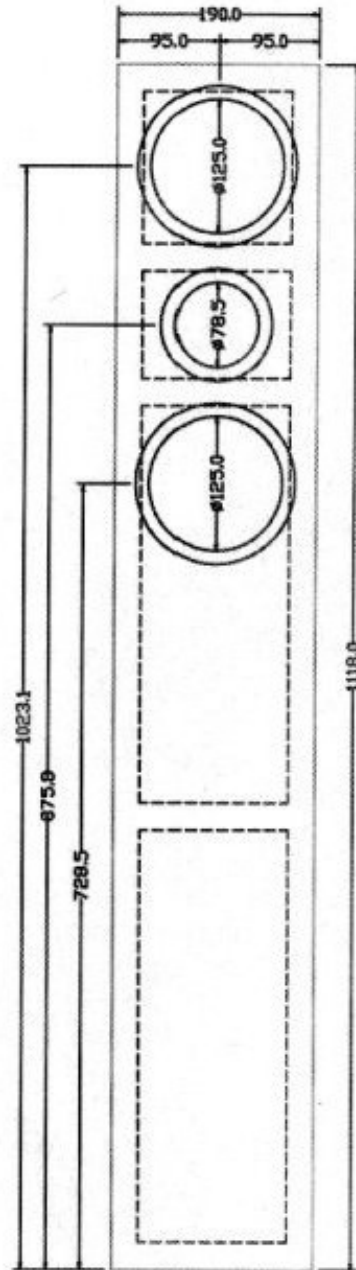

BAFFLE
FRONT VIEW

BAFFLE
SIDE VIEW

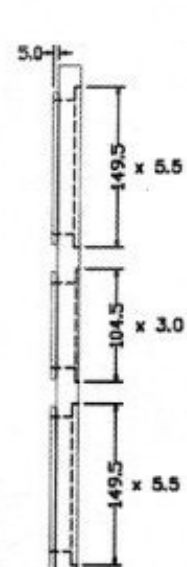

DÉTAIL
ÉVENT

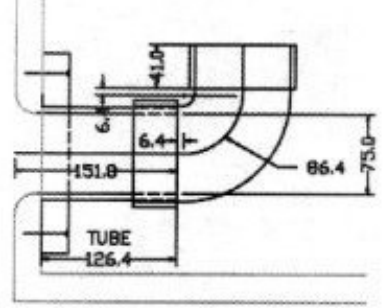

DÉTAIL
CEINTURES

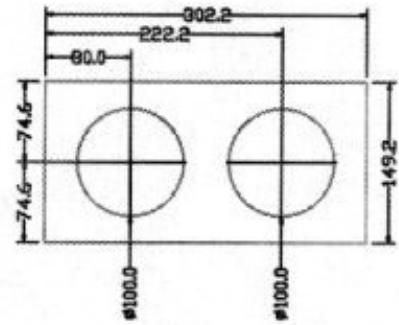

DESSUS/DESSOUS
FRONT VIEW

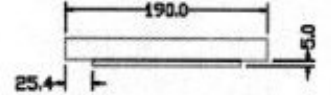

U/SIDE VIEW

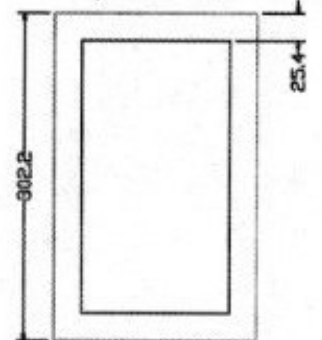

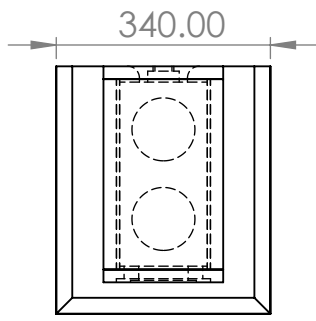

ITEM NO.	PART NUMBER	DESCRIPTION	QTY.
1	SSUR - Base_01		1
2	SSUR - Base_02		1
3	SSUR - Derrière		1
4	SSUR - Côté		2
5	SSUR - Devant		1
6	SSUR - Dessus & Dessous		2
7	SSUR - Ceinture		3

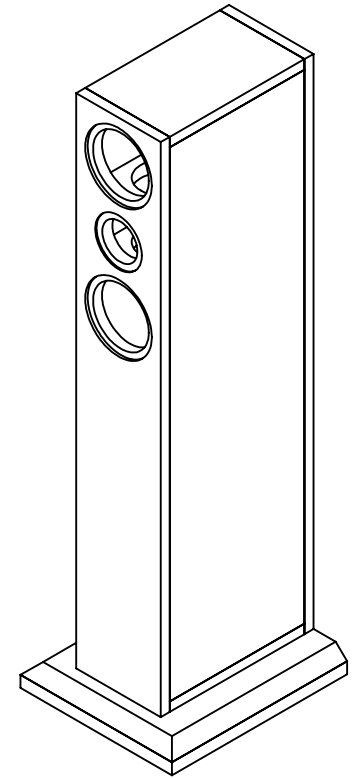
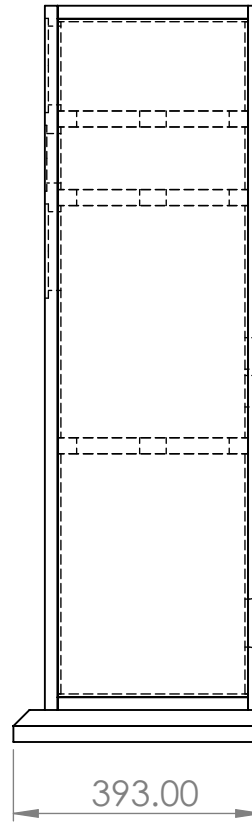
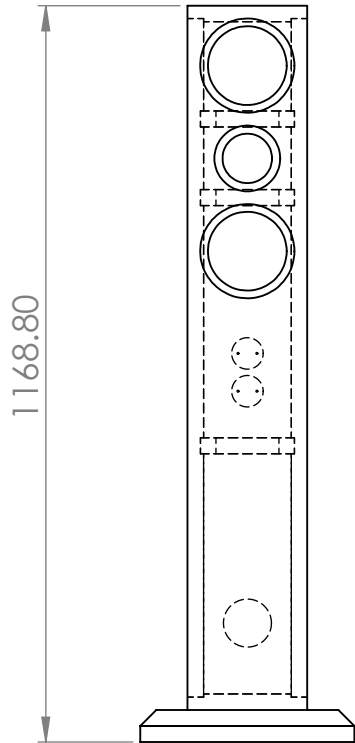

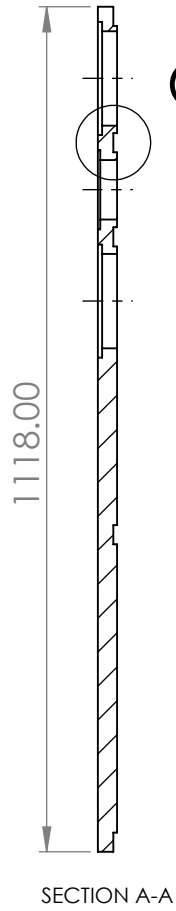
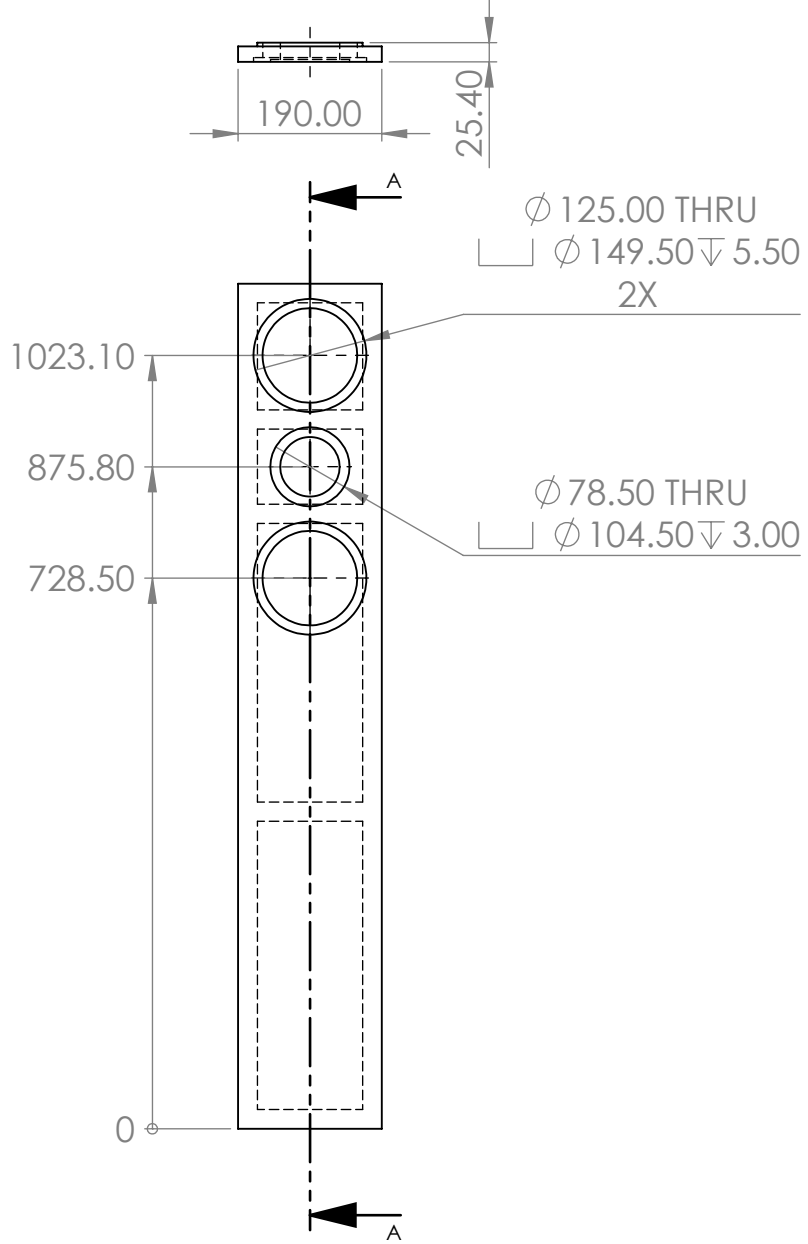

C

